

# **BALL VALVE KPT, FLANGED** **FULL BORE, DN15–DN250**

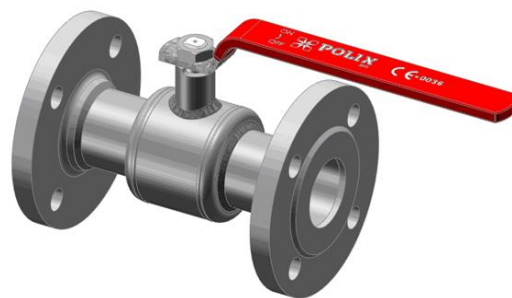

DN15–DN200

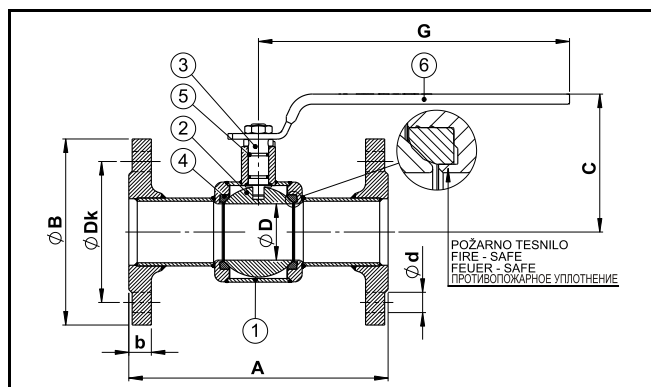
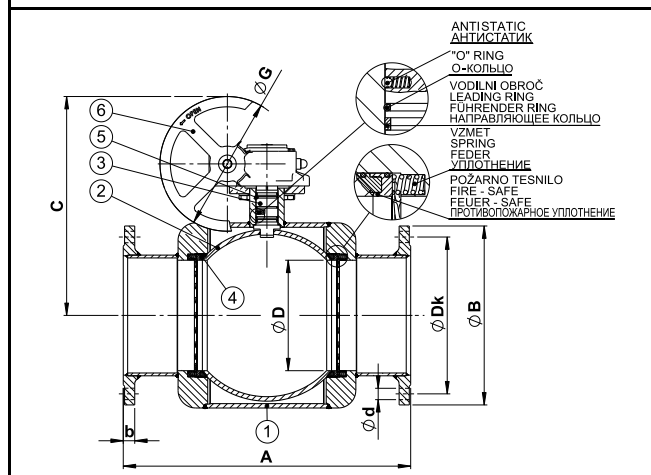

DN250



**Working temperature -20 °C/+200 °C**

## **Materials**

1	Body	Carbon Steel – A105, P235TR2
2	Ball	Stainless Steel – X5CrNi18-10 (A304)
3	Stem	Stainless Steel – X20Cr13 (A420)
4	Seats	PTFE
5	O-Ring	PTFE
6	Handle	Carbon steel (Galvanised), option S235JR (RSt 37-2)

## **KPT DN ... PN16 DP PX PX**

**PN16**

Art. nr.	DN	A	ØB	C	ØD	G	b	ØDk	Ød	Nr.	Weight (kg)
A958801	15	130	95	71,6	15,9	161	14	65	14	4	1,76
A958802	20	150	105	82,6	20	161	16	75	14	4	2,51
A958803	25	160	115	90,3	25	161	16	85	14	4	3,12
A958804	32	180	140	108,3	31	237	16	100	18	4	5,07
A958805	40	200	150	116	40	276	16	110	18	4	6,81
A958806	50	230	165	122,5	50	276	18	125	18	4	8,22
A958807	65	290	185	148,6	63,5	340	18	145	18	4	14,95
A958808	80	310	200	160,6	78	340	20	160	18	8	21,72
A958809	100	350	220	174,6	99	340	20	180	18	8	27,13
A958810	125	400	250	219	125	545	22	210	18	8	37,85
A958211	150	450	285	246	150	545	22	240	22	8	59,20
A958212	200	550	340	348	200	1000	24	295	22	12	102,90
A958213	250	650	405	495	250	Ø305	26	355	26	12	189,50

## KPT DN ... PN40 DP PX PX

PN40

Art. nr.	DN	A	ØB	C	ØD	G	b	ØDk	Ød	Nr.	Weight (kg)
A958201	15	130	95	71,6	15,9	161	16	65	14	4	1,96
A958202	20	150	105	82,6	20	161	18	75	14	4	2,73
A958203	25	160	115	90,3	25	161	18	85	14	4	3,49
A958204	32	180	140	108,3	31	237	18	100	18	4	5,62
A958205	40	200	150	116	40	276	18	110	18	4	7,23
A958206	50	230	165	122,5	50	276	20	125	18	4	8,96
A958207	65	290	185	148,6	63,5	340	22	145	18	8	16,45
A958208	80	310	200	160,6	78	340	24	160	18	8	23,42
A958209	100	350	235	174,6	99	340	24	190	22	8	29,91
A958210	125	400	270	219	125	545	26	220	26	8	40,24
A958811	150	450	300	246	150	545	28	250	26	8	52,43
A958812	200	550	375	348	200	1000	34	320	30	12	106,20
A958813	250	650	450	495	250	Ø305	38	385	33	12	219,90



FLANGES 40 BAR - MAXIMUM ALLOWABLE PRESSURE: DN65-DN125 = 25 bar  
DN150-DN250 = 16 bar

**Notes**

Face to face dimensions conform to DIN3202 F17.

Fire safe design

DN250: - spring loaded washers

- antistatic design

- manual gearbox



**POLIX**  
ŽIRI